

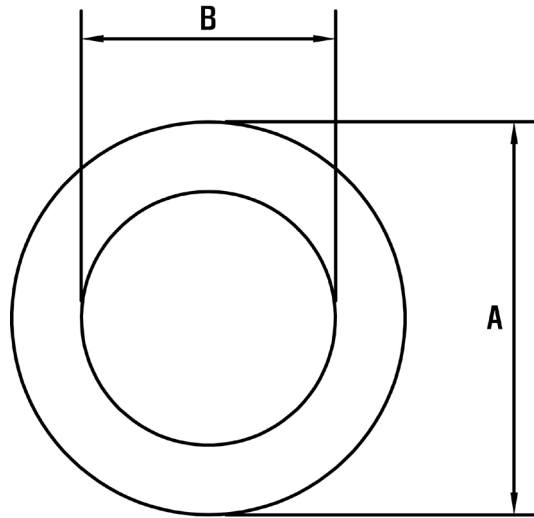

CORES OF ZERO - CURREN - TRANSFORMER (Ø17.8, Ø13.35, Ø13.0, Ø12.2)



TOLERANCE $\pm 0.05\text{mm}$

RING CORE STANDARD SIZE

TYPE	CORE SIZE(mm)		
	A	B	THICKNESS
Ø17.8	17.8	13.35	0.35
Ø13.35	13.35	9.85	0.35
Ø13.0	13.0	9.3	0.345
Ø12.2	12.0	8.8	0.345

OUTPUT VOLTAGE CHARACTERISTICS

TYPE	SHEET	f	I ₁	N ₁	N ₂	R _L	V _o
Ø17.8	5PCS	60Hz	20mA	1TURN	Ø0.1x950Turns	820	12.9mV MIN
Ø13.35	4PCS	60Hz	20mA	1TURN	Ø0.09x950Turns	820	12.8mV MIN
Ø13.0, Ø12.2	5PCS	60Hz	20mA	1TURN	Ø0.1x1000Turns	1KHz	17.0mV MIN

